

Made in the USA

MATERIAL
ASTM A48 Class 30 Cast Iron

SLEEVE WEIGHT
64.5 LBS.

FINISH
POWDER COAT FINISH
1 coat zinc rich epoxy primer + 1 coat
Super Durable polyester powder coating.
Available in 25 colors.

INSTALLATION
MOUNTING OPTIONS AVAILABLE
-Type P - Pipe Mount
-Type I - Iron Base
-Type S - Surface Mount

See specific Installation drawings for each
mounting option. The installation drawing
will show the component weight chart,
mounting instructions, and details.

TYPE P
Pipe Mount

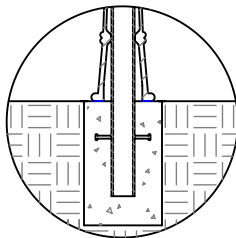

TYPE I
Iron Base Mount

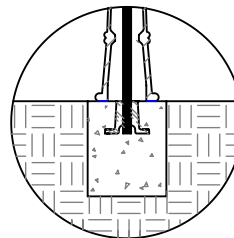

TYPE S
Surface Mount

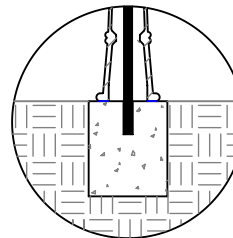

Optional Eye Bolt and Chain

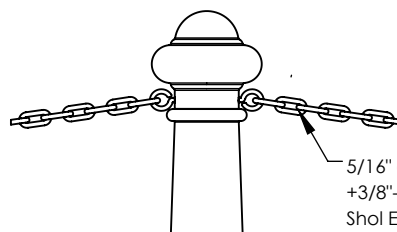

5/16" quick link chain
+3/8"-16 x 1 Stainless Steel
Sho1 Eye Bolt. Powder coated.

Series: Promenade

Product No.

100-QT



BOLLARDSUSA
A DIVISION OF JR HOE

PROPRIETARY AND CONFIDENTIAL - THE INFORMATION CONTAINED IN THIS DRAWING IS THE SOLE PROPERTY OF J.R. HOE & SONS INC. ANY REPRODUCTION IN PART OR AS A WHOLE WITHOUT THE WRITTEN PERMISSION OF J.R. HOE & SONS INC. IS PROHIBITED.

5

↑

4

3

2

1